

Archaeological Site Avoidance Plan

**The Christian LaGrange Farmstead and
Cemetery Historic Archaeological Site
(A00102.000613)**

**Vista Technology Park Project,
#06PR00226**

**Towns of Bethlehem and New Scotland,
Albany County,
New York**

prepared for

BBL Development Group, LLC
302 Washington Avenue Extension
Albany, NY 12203

prepared by

David Moyer , RPA
Birchwood Archaeological Services
2948 County Highway 35
Sidney Center, NY 13839
Phone: 607-265-3444
Fax: 607-265-3459
E-mail: birchwoodarch@yahoo.com

March 2007

Introduction

The Christian Lagrange Farmstead and Cemetery Historic Archaeological Site (A00102.000613) was initially identified as part of the Vista Technology Park Project, PR#06PR00226, located in the Towns of Bethlehem and New Scotland in Albany County New York (Figures 1 and 2). The site includes a late 18th early 19th century farm complex including outbuildings and a small family cemetery. As part of the project, a proposed traffic loop will encircle the site to connect to the various buildings. The house and cemetery will be preserved as part of the project, and with the exception of some light landscaping and brush removal, will not be impacted by the proposed construction. This plan has been developed as a means of protecting the Christian LaGrange site from ground disturbance during the construction of adjacent areas of the site.

Background

The Christian Lagrange Farmstead and Cemetery Historic Archaeological Site consists of a rural farm complex with a small cemetery, structures and outbuildings dating from the late 18th through the early 20th centuries. The site includes the main farmhouse, a standing barn, and several smaller outbuildings. The site also encompasses a small cemetery and several other landscape features, including wells, cisterns, a concrete pad, and the stone ramp into a non-extant barn. Most of the buildings appear to date from the late 19th through early 20th centuries. The cemetery is located in the northern part of the site and consists of four headstones and four footstones ranging in age between 1828 and 1859. More information about the site is included in the Phase II report (Moyer 2007).

The LaGrange Family has been long established along the banks of the Normanskill, beginning in 1700 when the family moved from Albany to the New Scotland Vicinity. Omie LaGrange, a prominent trader and land owner, originally purchased land encompassing 35,000 acres from Jan Hendrickse Vroman in 1686 for one hundred beaver skins. The current house was known to have been occupied by Christopher I. LaGrange, grandson of Omie, born on August 27, 1779, who died there July 24, 1848. His grave lies in the small cemetery to the east of the house. He married his first cousin, Jemima LaGrange, who lies buried beside him. Two of their sons, Abram and Christian C. LaGrange, are also buried at the small cemetery at the site.

Because of the historic significance of the site and the quantity and diversity of artifacts in the close vicinity of the house and outbuildings, the site would likely be determined eligible for inclusion in the National Register of Historic Places by the NYSOPRHP for its ability to reconstruct past lifeways in the rapidly disappearing landscape of rural Albany County. For these reasons, the site should be avoided wherever possible. In order to protect the site during the construction process, several steps will be taken to avoid ground disturbance within the site boundaries.

Proposed Avoidance Measures

As a means of avoiding potential ground disturbance within the site boundaries, the following measures will be implemented prior to construction. These measures are designed to prevent the accidental or unintentional disturbance to the Christian Lagrange Farmstead and Cemetery Historic Archaeological Site prior throughout the duration of the proposed construction. Each of these measures is discussed individually below.

Awareness- The most important component of any successful archaeological site avoidance is awareness on the part of the construction personnel about the location, boundaries and extent of the site itself. Prior to construction, all contractors, subcontractors, and construction personnel will be made aware of the significance of the site and need for avoidance as well as the exact location and boundaries of the site to be avoided. No ground disturbance, including the moving of heavy machinery, construction staging, or equipment storage will be conducted within the confines of the site boundary.

Safety Fencing- A fence of 36 inch high visibility orange barricade fencing will be installed around the entire protective boundary prior to the initiation of any ground disturbance as shown in Figure 2. All contractors, subcontractors, and construction personnel will recognize the barricade fence as the site boundary, and will not conduct any ground disturbing activities within that area. This barricade fencing will remain standing throughout the duration of the construction process and will only be removed following the completion of the roadways and utilities.

Erosion Control- As part of the proposed avoidance measures, black silt fencing will be installed around the site boundary and orange barricade fencing to prevent erosion from the site during the construction as well as to soil from depositing on to the site from rainfall and soil runoff on higher adjacent areas (Figure 2). Like the barricade fencing, this silt fence will remain standing during the entire duration of the proposed ground disturbance and will only be removed after revegetation measures have been taken in the proposed construction areas.

Accidental Discoveries- In the event that historic archaeological deposits associated with the Christian LaGrange Site, such as refuse middens, wells, cisterns, foundations and other archaeological and landscape features, are encountered during the construction of the roadways adjacent to the site, construction will stop immediately and a qualified professional archaeologist will be contacted before construction resumes in this area. Construction in other parts of the parcel may continue during this period unless additional remains are identified close by. Only after the discovery has been adequately documented by the archeologists will construction be able to proceed.

Human Remains- Because of the presence of a historic cemetery on the LaGrange site, and because of the high number of prehistoric sites located in the

vicinity, the potential exists for encountering human remains as part of the construction for the proposed technology park. In the event that burials or human remains are unearthed, all fieldwork will immediately halt until further consultation with NYSOPRHP regarding these finds is acquired. If any human remains are encountered, the area will be secured to protect it from disturbance. All remains will be left in place until all necessary agencies/concerned groups are contacted. At that time, a plan relevant to the specific discovery and in accordance with all state, federal, and local laws, and NYAC guidelines will be developed and implemented. All burials will be treated with the utmost dignity and respect.

Taken as a whole, the above measures should help to protect the Christian LaGrange Farmstead and Cemetery Historic Archaeological Site during the construction of the proposed technology park, which will ultimately surround the site on all sides. Careful implementation of this plan will help to ensure that this site remains intact and available for future generations to study and enjoy.

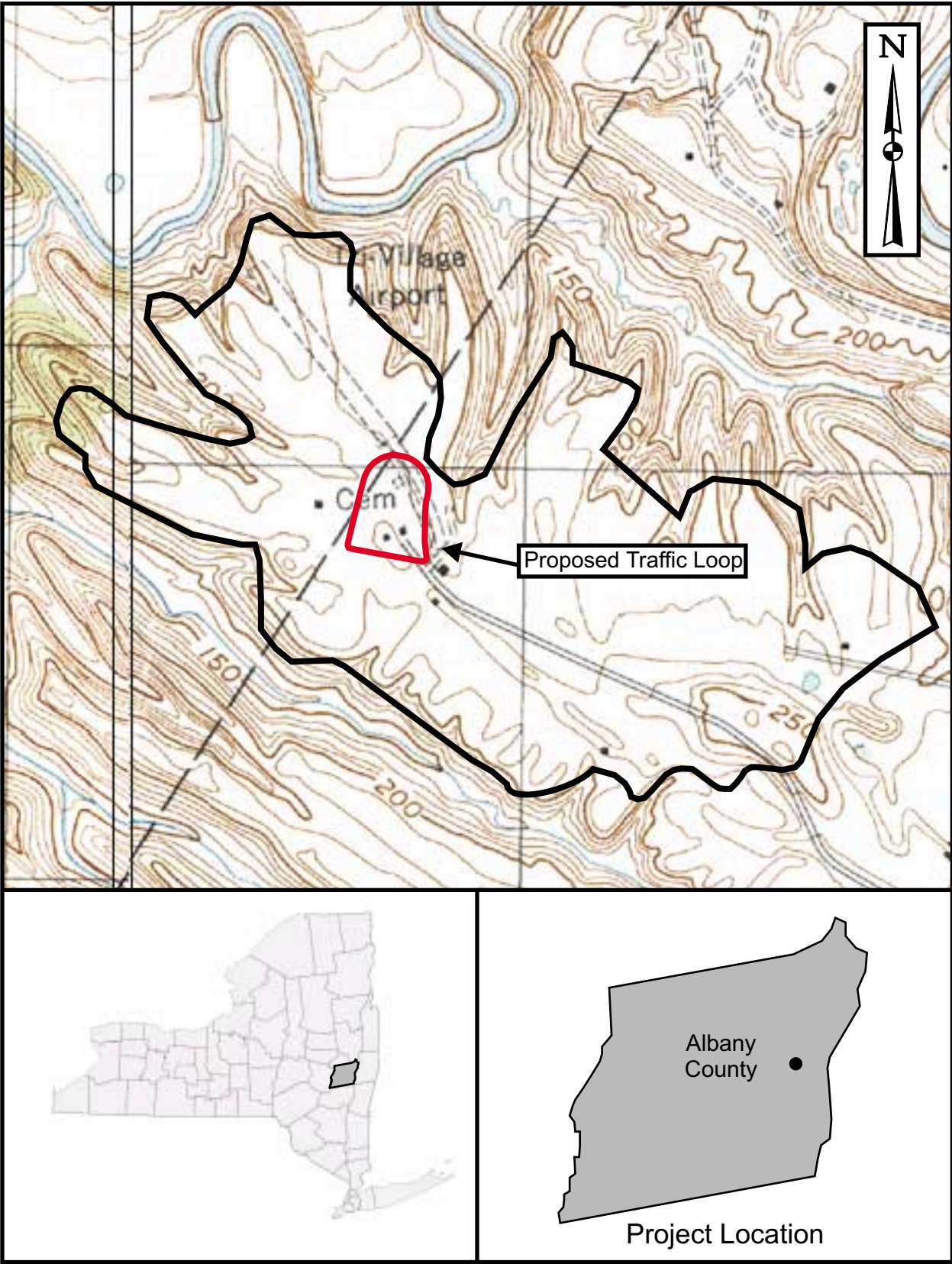

Figure 1. Map showing the location of the proposed traffic loop at the proposed Vista Technology Park.

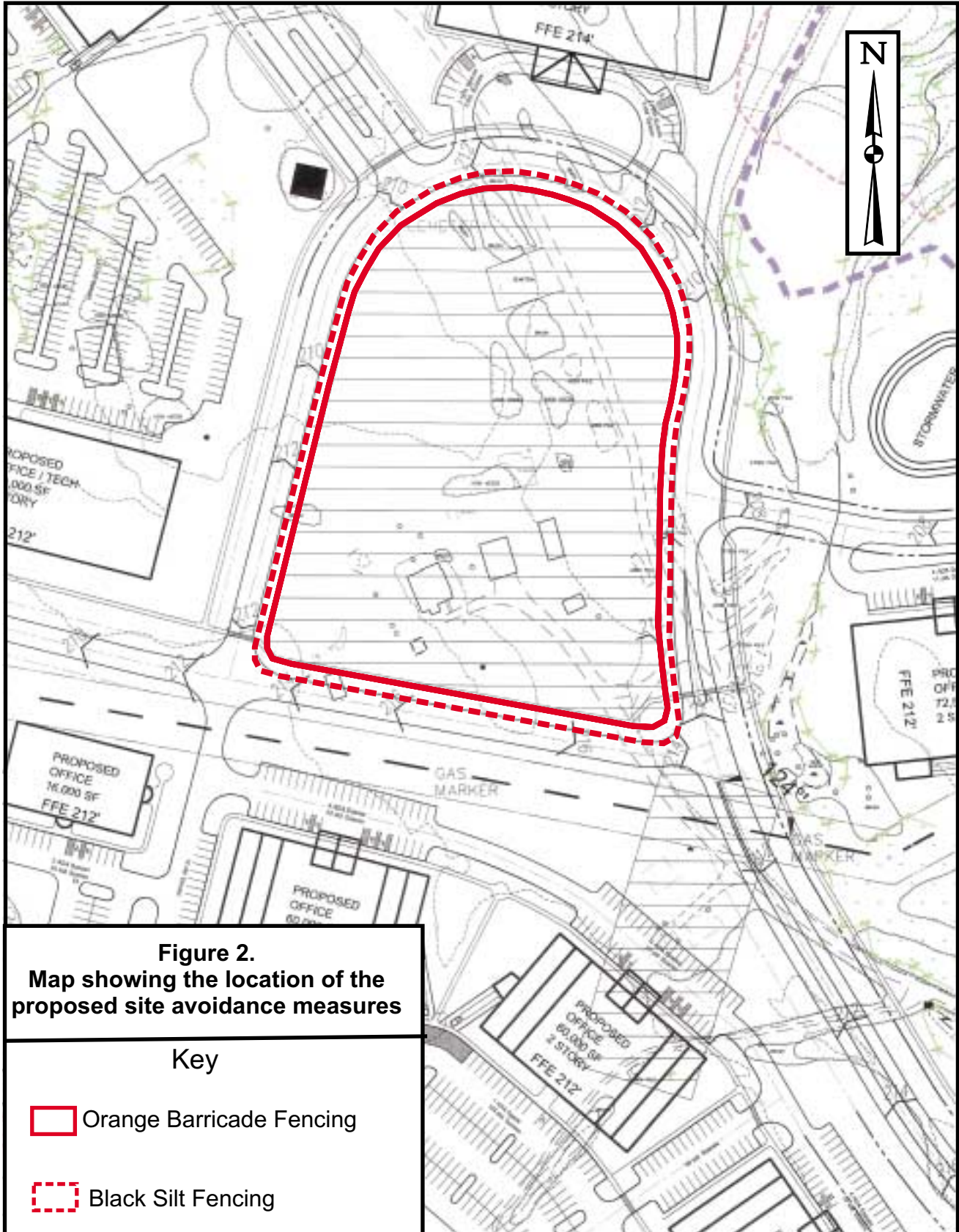



Figure 2.
Map showing the location of the proposed site avoidance measures

Key	
	Orange Barricade Fencing
	Black Silt Fencing